

<u>Fullblood</u>	<u>Purebred</u>	<u>Fullblood</u>	<u>Picks</u>	<u>Fullblood</u>	<u>Purebred</u>
1A-D	66	9	8	62	65
1E	66A	25	10	58	74
1F	66B	31	<u>Purebred</u>	57	68
1G	23	29	3	63	68A
1H-J	23A-C	61A	4	53	69
2	80	61B	4A-B	54	70
2A	52	61C-G	39	34	81
2B	6	60	39A-J	36	51
2C	5	60A	47	37	50
18	7	20	40	55	48
18A	22	19	40A-B	56	46
21	22A-C	19A	41	64	45
26	77	86	41A	35	24
26A-D	67	28	43	38	72
27	67A-D	28A-C	49	87	76
27A-D	75	30	44	88	78
59	75A-B	32	42	89	79
59A	15	33	42A-E		71
11	16	14	83A-C		73
	17	12	82		85A-B
			84		

**Sale Updates**  
 Lot 18a is hetero polled and non-diluter  
 Lot 40 is homo black  
 Lot 73 is homo polled and non-diluter

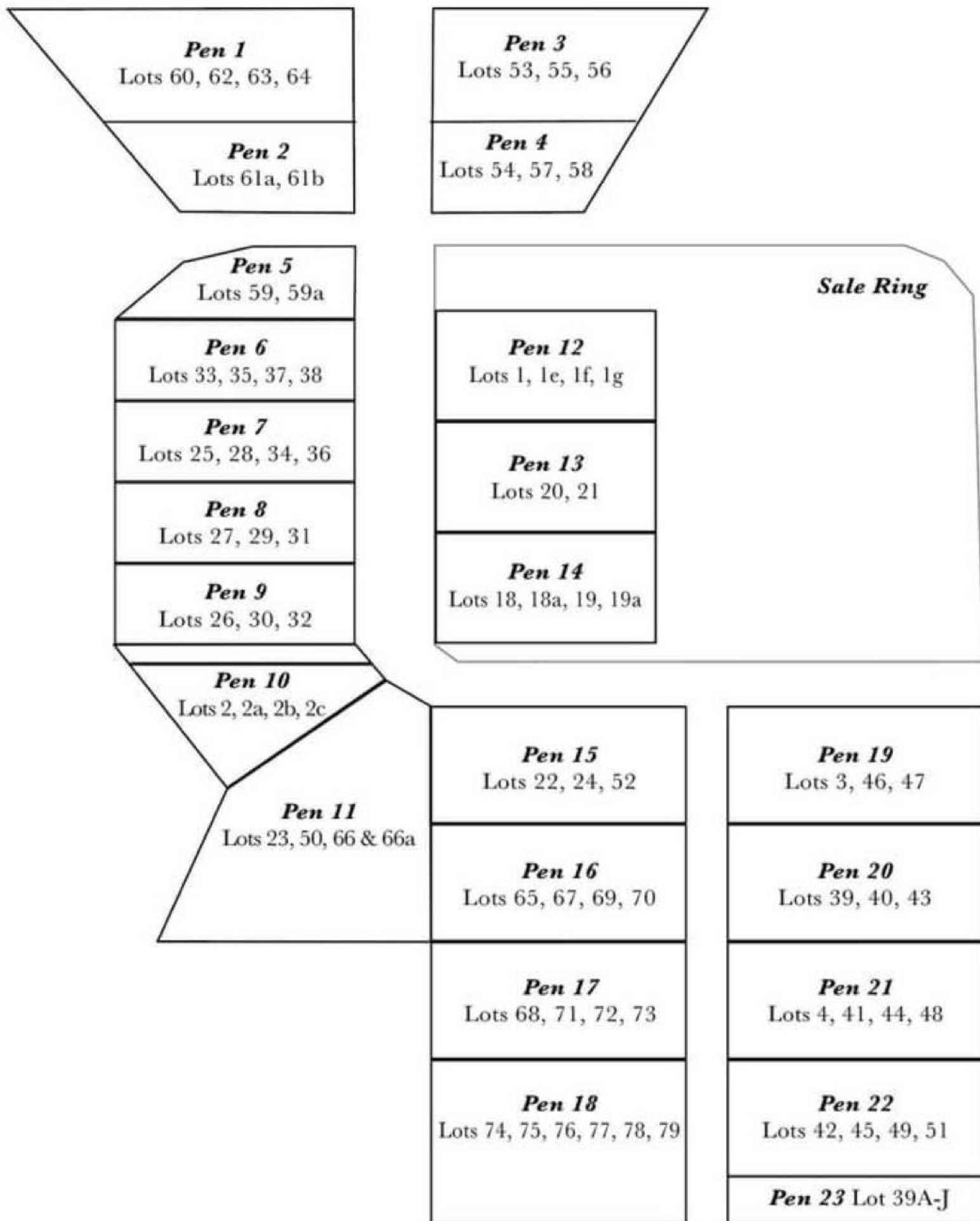

**Display Area**

Cattle on display from Canadian Donors, Canadian Sires, Twin Meadow & Trendsetter/Big Valley (note, the bred is a full sib to 87 embryos)